



13th annual
MID-VALLEY

yard, garden & patio SHOW

March 19, 20, 21, 2010

Now announcing the dates for this much anticipated event to help welcome Spring and grow your business with thousands of potential customers. The Mid-Valley Yard, Garden & Patio Show is a showcase of the latest in outdoor living, gardening trends, and design ideas for your yard and garden plus the very latest in garden tools and equipment. Be among the many exhibitors to display your products and services at the most colorful show of the year in the Willamette Valley!

For more information or to reserve your space today contact the Home Builders Association at (503) 399-1500 or (800) 345-9366.

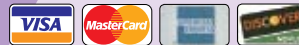

yard, garden & patio show show hours

Friday, March 19	11 am - 6 pm
Saturday, March 20	9 am - 6 pm
Sunday, March 21	10 am - 5 pm

jackman-long building

Aisle	\$500
Perimeter	\$550
Corner	\$600
Perimeter Corner	\$1200
Booth 10 – Approx. 10 x 30	\$1200

Nursery & Landscape

Special Feature Displays Available
Call for more information and pricing.

Each booth is furnished with back and side drapes and one electrical outlet up to 1000 watts capacity.

All booths are 10 x 10 unless otherwise noted.

Floor plan, move-in & move-out hours, and exhibit hours are subject to modification without notice.

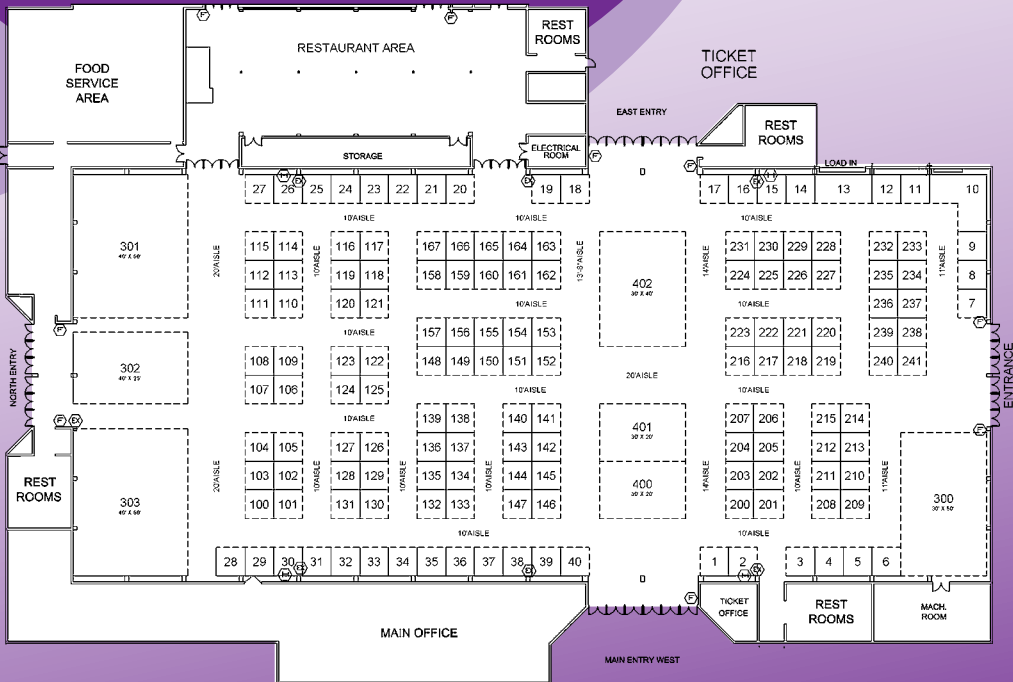

Reserve your space today!

33RD ANNUAL Mid-Valley HOME SHOW

**NEW GREEN
LIVING SECTION**

**JANUARY
15, 16 & 17, 2010**

The Home Builders Association of Marion & Polk Counties' Mid-Valley Home Show is celebrating its 33-year as the oldest, largest and best attended home show in the Mid-Willamette Valley. Don't miss this amazing opportunity to showcase your goods and services to thousands of potential customers at the 2010 Mid-Valley Home Show!

This year's show will include a "Green Living" Special Feature section in Columbia Hall. To qualify for this special section, vendors must offer a "green" or sustainable product or service. Participation in this section is subject to approval by show management and the HBA's Green Building Council.

Contact the Home Builders Association at (503) 399-1500 or (800) 345-9366 to reserve your space today!

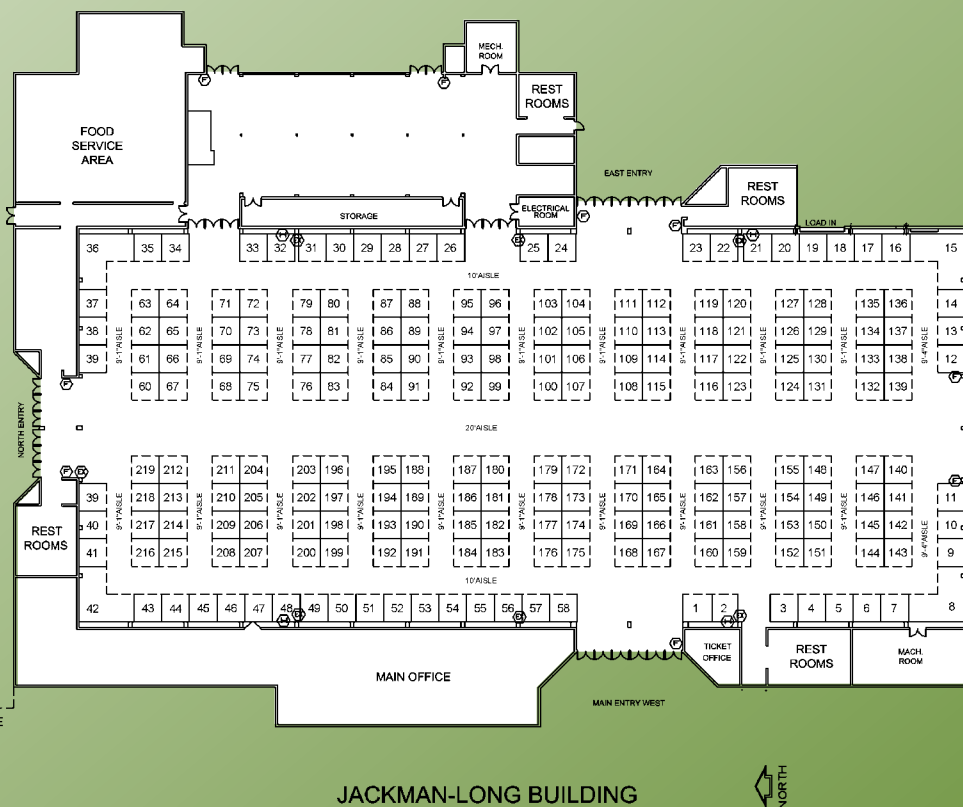

MID-VALLEY HOME SHOW

columbia hall

jackman-long building

Corner	\$600
Green Living Special Feature Section (highlighted in green) Must meet qualifications as listed	\$500
Perimeter Corner Booths 300-301, 305-306, 307-308 – Approx. 20' x 20'	\$1000

Aisle	\$675
Perimeter	\$725
Corner	\$750
Perimeter Corner Booths 8, 15, 36, 42 – Approx. 10' x 30'	\$1500

show hours

Friday, January 15	1 pm - 8 pm
Saturday, January 16	10 am - 8 pm
Sunday, January 17	10 am - 5 pm

Each booth is furnished with back and side drapes and one electrical outlet up to 1000 watts capacity. 220 volts is available at an additional cost.

All booths are 10 x 10 unless otherwise noted.

Floor plan, move-in & move-out hours, and exhibit hours are subject to modification without notice.

